

SMART TOUGH 212

Linux-Based Hybrid-Biometric Access Control & Time and Attendance Terminal with Full Spectrum of Authentication Options Ip65



Facial Recognition



RFID



Fingerprint



QR Code



IP65 dust & waterproof rating



HD Video Door Phone



Smart Tough 212

The Smart Tough 212 uses intelligent engineering facial recognition algorithms and the latest computer vision technology, featuring a video intercom function.

What sets the Smart Tough 212 apart is its 4-inch color LED touch screen, a 2MP binocular camera, a built-in microphone, and a speaker for two-way video communication. There are two ways to use video intercom functions. Firstly, users can have a video phone through the WebSmart app when connected to the internet. Secondly, the terminal can connect the indoor station via SIP protocol.

The Smart Tough 212 can also integrate with the WebSmart Mobile Page to support Dynamic QR codes for access control or time and attendance protocols. Furthermore, the Smart Tough 212 incorporates the ultimate anti-spoofing algorithm for facial recognition, protecting most fake photos and video attacks. The terminal also supports specialized QR modules such as QR code, PDF417, Data Matrix, MicroPDF417, and Aztec.

Features

- Visible light facial recognition technology and in-glass fingerprint verification.
- Visible light facial recognition in dimly lit environment even without supplement light.
- Full spectrum of authentication methods: support facial recognition/ fingerprint verification/ scramble QR Code/ Card/ Password (Virtual Keypad).
- Supports multiple RFID modules: 125 kHz ID card / 13.56MHz IC card / ID & IC card.
- Enlarged Capacity: 3,000 (facial recognition) / 3,000 (fingerprint) / 3,000 (RFID card) / 200,000 transactions.
- HD video door phone via WebSmart mobile app / SIP protocol.
- Reached IP65 protection rating with waterproof and dustproof.

Specifications

Model	Smart Tough 212
Display	4"@ TFT Color Touch LED Screen (480X800)
Camera	Binocular Camera @ 2MP
Operation System	Linux
Hardware	CPU: Dual Core@1GHz RAM: 1GB; ROM: 8GB Speaker: 8 ohm@1 W Microphone: *1 (Sensitivity: -32dB / Omni-directional / Signal-to-Noise Ratio: 58dB / Impedance: 2.2kΩ) Fingerprint Sensor: In-Glass Fingerprint
Authentication method	Face / Fingerprint / Card/ Password (Virtual Keypad)
User Capacity	3,000(1:N) (Standard)
Face Template Capacity	3,000 (1:N) (Standard)
Fingerprint Template Capacity	3,000 (1:N) (Standard)
Card Capacity	3,000 (1:N) (Standard)
Transaction Capacity	200,000 (1:N)
Max. User Password Length	8 Digits
Biometric Verification Speed	less than 0.35 second (Facial Recognition) less than 0.5 second (Fingerprint Recognition)
Touchless Biometric Recognition Distance	30cm to 170cm @Face
False Acceptance Rate (FAR) %	≤0.01% (Facial Recognition) ≤0.0001% (Fingerprint)
False Rejection Rate (FRR) %	≤0.02% (Facial Recognition) 0.01% (Fingerprint)
Biometric Algorithm	SmartFace V3.9 & SmartFinger V10.0
Card Type	ID Card@125 kHz (Optional), IC Card@13.56 Mhz
Communication	TCP/IP*1 Wi-Fi Wiegand (Input & Output)*1 RS485: Smart RS485*1 USB: Type A (USB Drive Only)*1 Aux Inputs *1, Electric Lock*1, Door Sensor*1, Exit Button*1, Alarm output*1, Wired Doorbell*1
Standard Functions	ADMS, DST, 14-digit User ID, T9 Keyboard (Input), Photo Capture, Event Photo Capture, Record Query, Tamper Switch Alarm, Automatic Status Switch, Multiple Verification Methods, Anti-Passback, Wired Doorbell, Schedule Bell, HTTPs / SSH Backend Access, AC Push and TA Push Protocol Switch
Power Supply	DC 12V 3A (Optional)
Operating Temperature	-5°c to 45°c
Operating Humidity	10% to 90% RH (Non-condensing)
Dimensions	183 mm X 88 mm X 20.5 mm (L X W X H)
Gross Weight	0.503kg
Net Weight	0.453 Kg
Supported Software	Software: WebSmart
Installation	Wall-mount (Compatible with Asian Gang-box / Single Gang-Box)
Ingress Protection Rating	IP65 (waterproof and dustproof)

Configuration

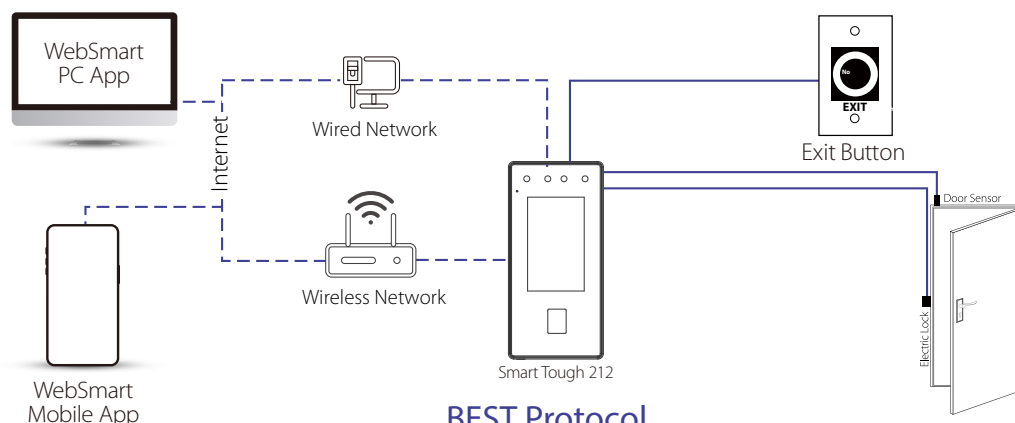

BEST Protocol

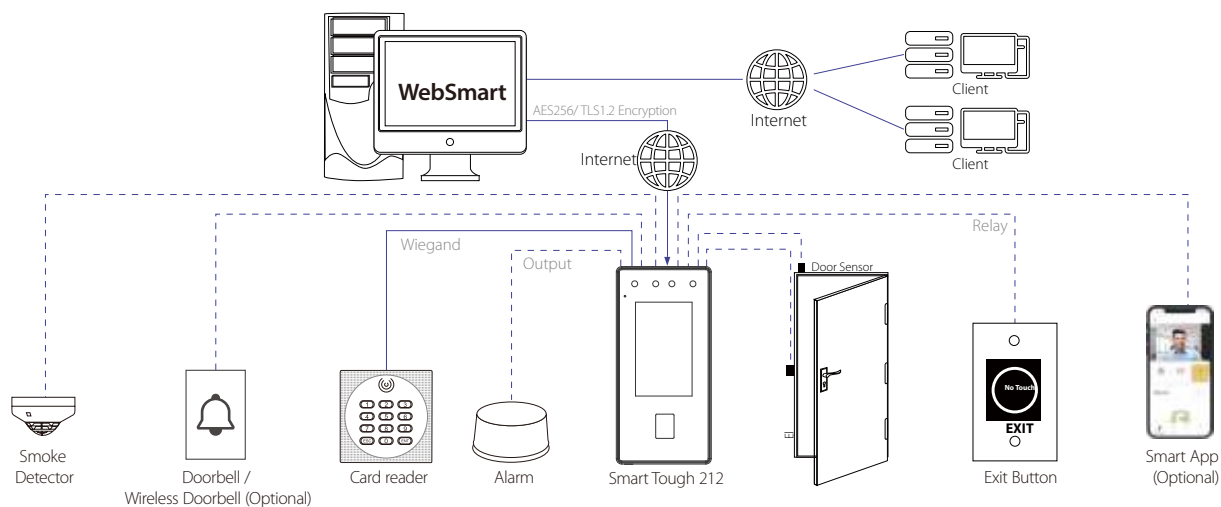

PUSH Protocol

Dimensions (mm)

Dimensions (mm)

